

Android Settings for EasySense, EasyTouch and EasyPatch (Samsung Galaxy Note 10 & A40)



1. Connections Settings

- Make sure your smart device's **Bluetooth** is available and turn it on.

Settings→**Connections**→**Bluetooth**

- Connect your smart device to Internet via **WLAN** or mobile data.

Settings→**Connections**→**WLAN**

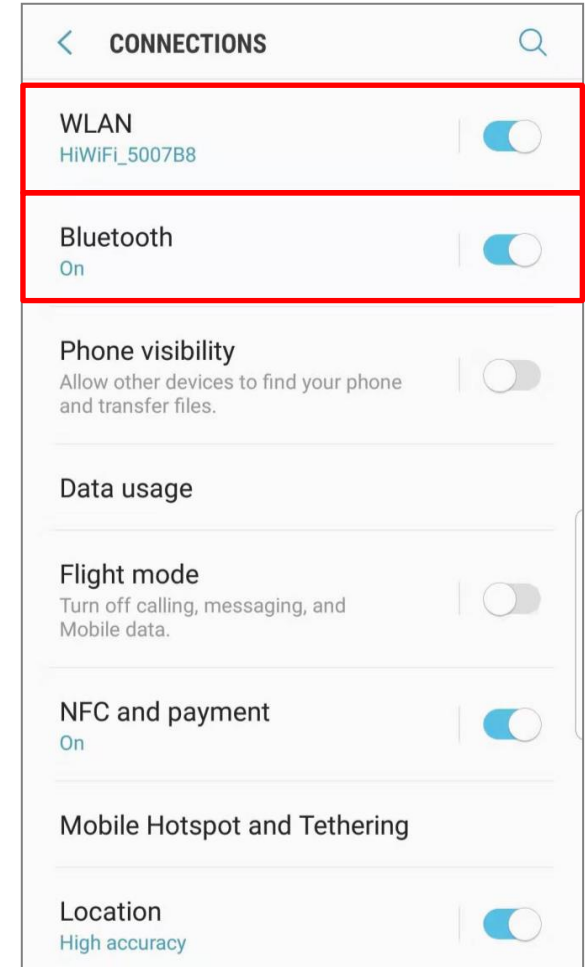

2. Notifications Setting

- Turn on **Notifications** and allow Medtrum App to show notifications on the status bar.
- Turn off **Silent** and **Do Not Disturb** functions

Settings→**Notifications**→**Medtrum apps**

or

Settings→**Apps**→**Medtrum App**→**Notifications**

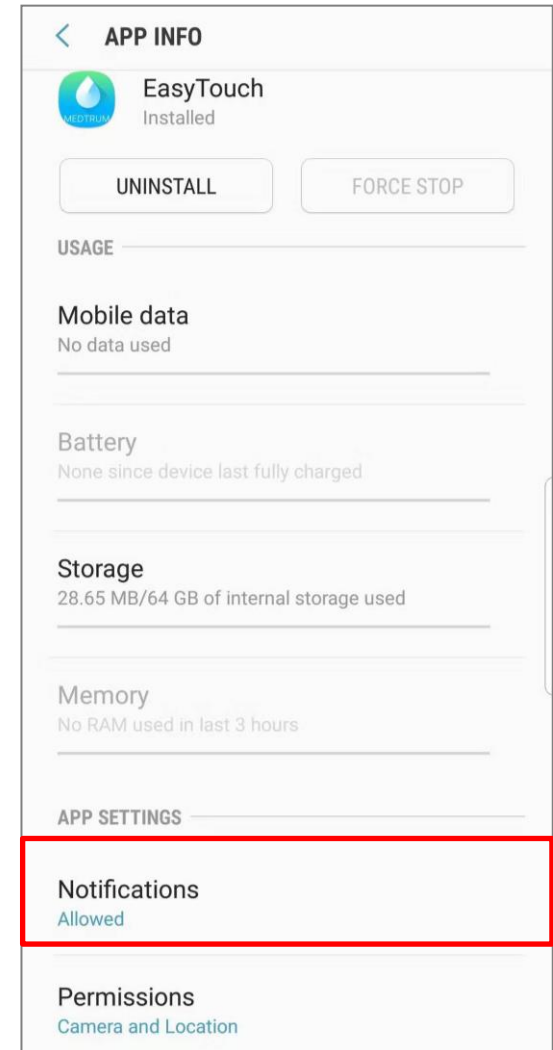
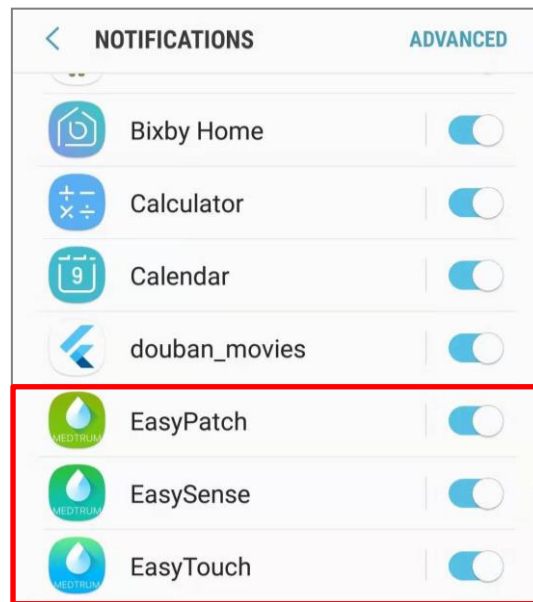

3. Location Setting

- Turn on **Location** so that the Bluetooth feature can be used.

For Android system below 10.0:
Settings→**Connections**→**Location**

For Android system 10.0 and above:
Settings→**Location**

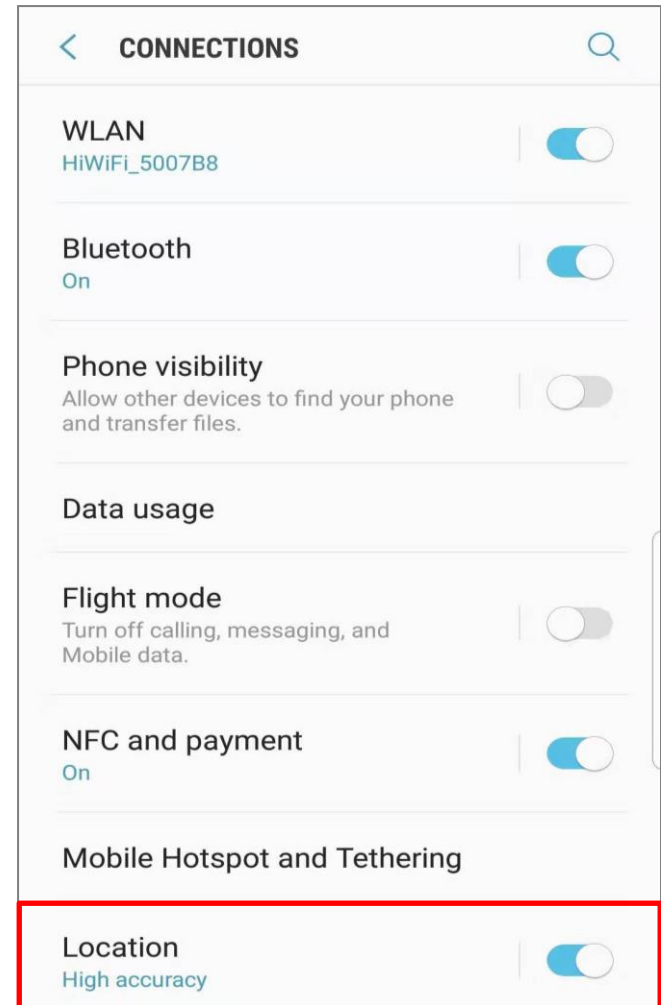
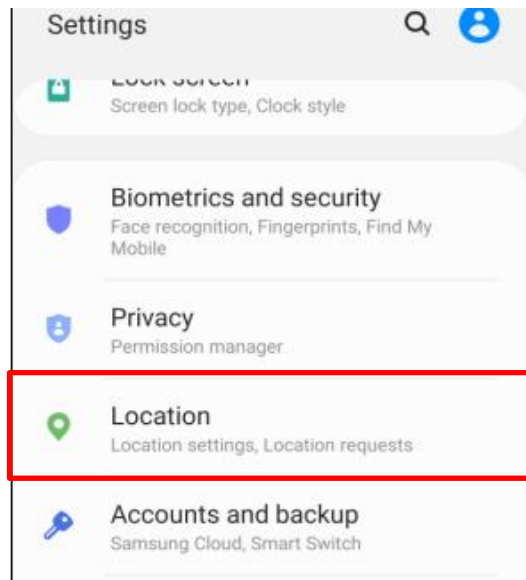

4. App Permissions Setting

- Allow Medtrum App to use **Camera**, **Location** and **Storage**

For Android system below 10.0:

Settings→ **Apps**→**Medtrum App**→**Permission**

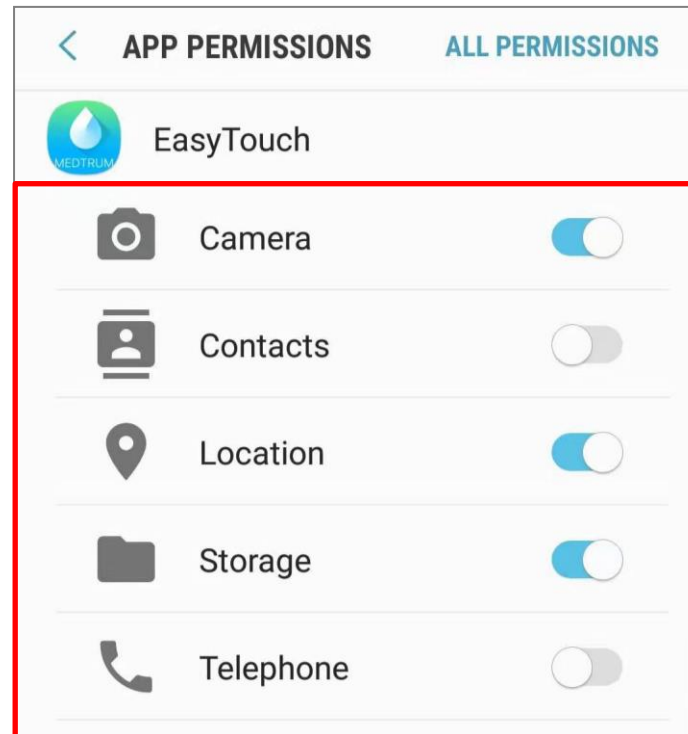

4. App Permissions Setting

For Android system 10.0 and above:

Settings → **Apps** → **Medtrum App** → **Permissions**

Note: Allow **Location** to be used all the time.

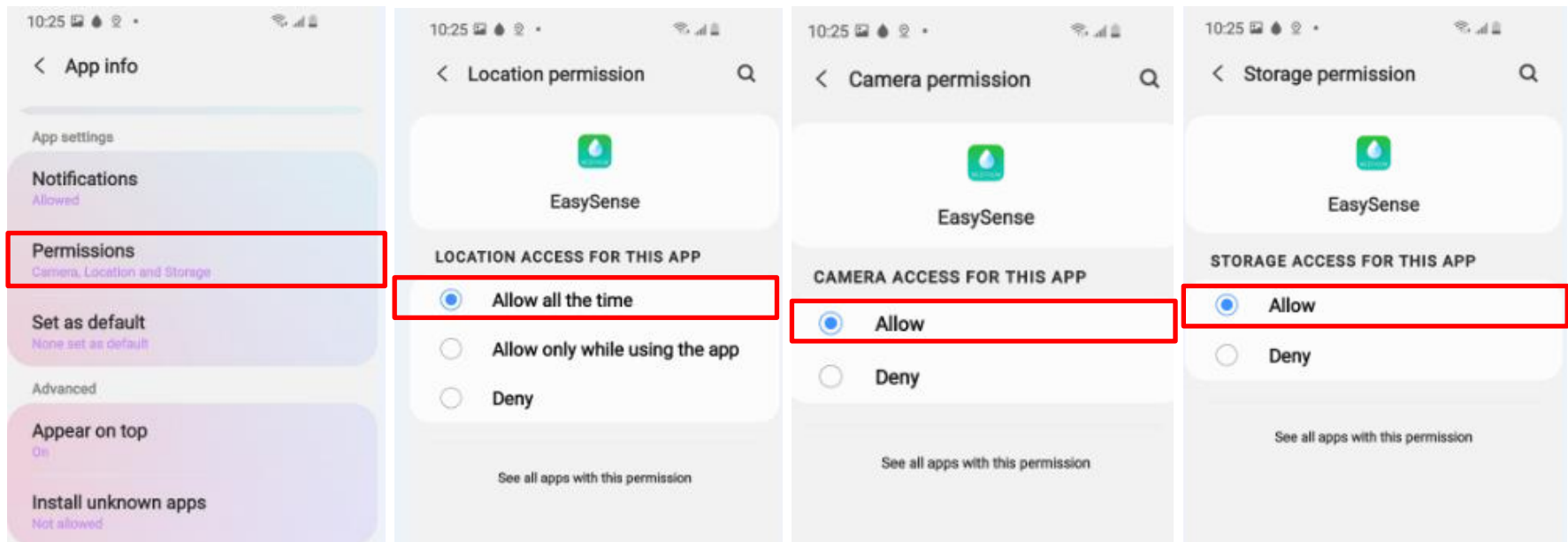

5. Battery Settings

- Turn off **Optimise battery usage** for Medtrum App.

Settings→Apps→Special access→Optimise battery usage→Medtrum App

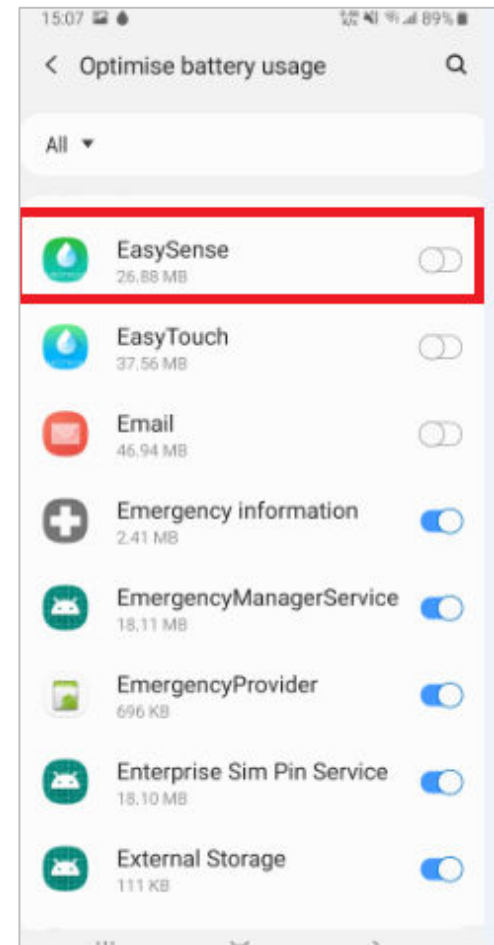
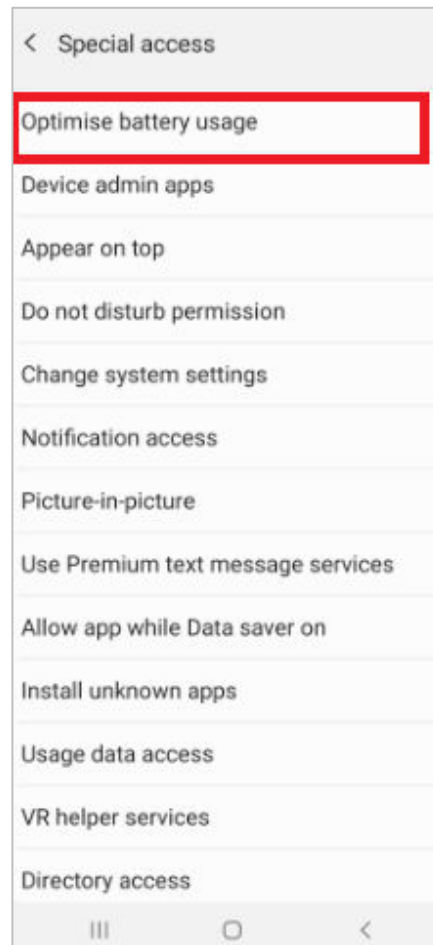
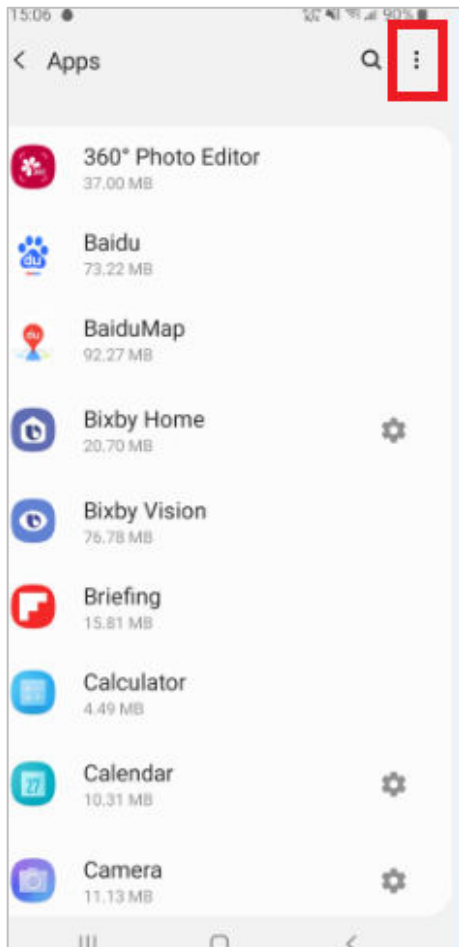

5. Battery Settings

- Select **Optimised** for Power Mode.

Device care → Battery → Power mode → Optimised

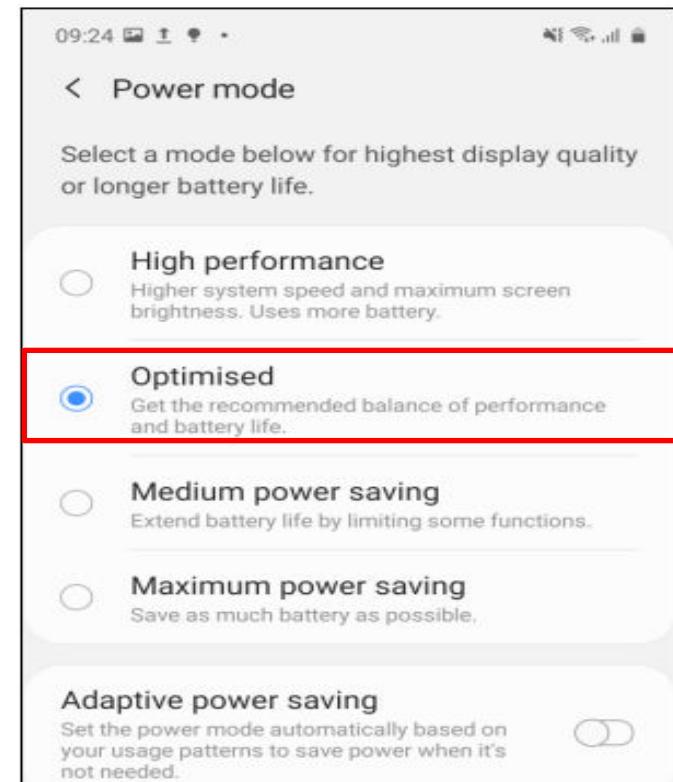

5. Battery Settings

- Turn off **Adaptive battery** and **put unused apps to sleep**.

Device care → Battery → App power management → Adaptive battery

Device care → Battery → App power management → Put unused apps to sleep

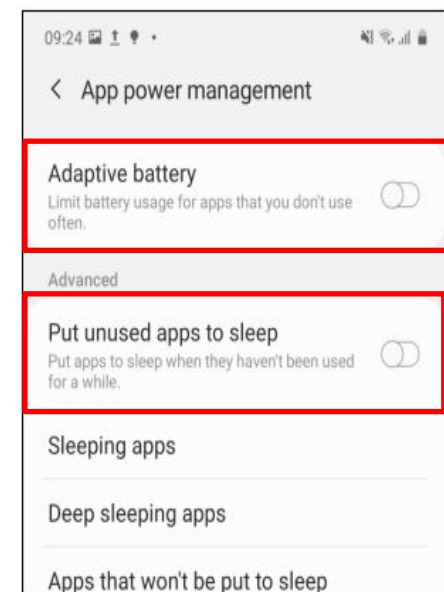
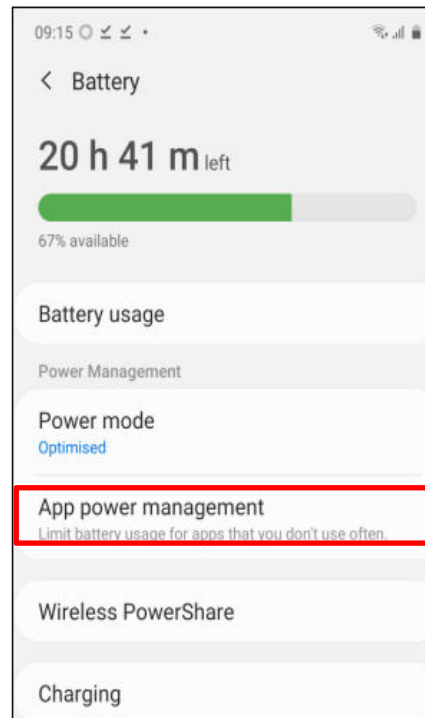
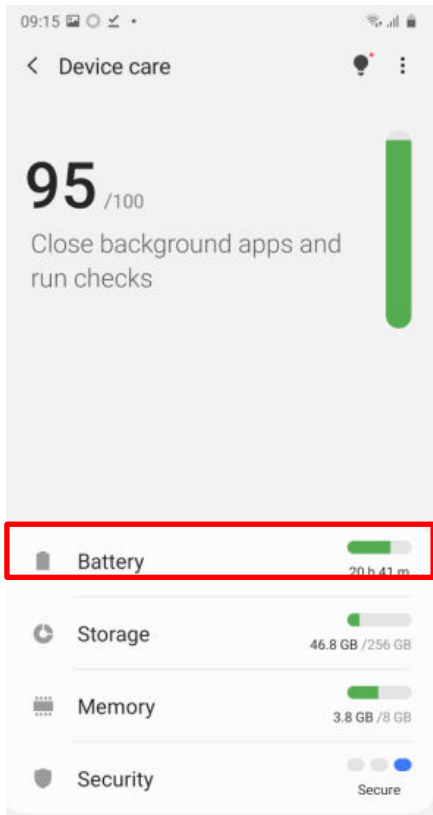

5. Battery Settings

- Add Medtrum App in **Apps that won't be put to sleep** lists

Device care→**Battery**→**App power management**→**App that won't be put to Sleep**

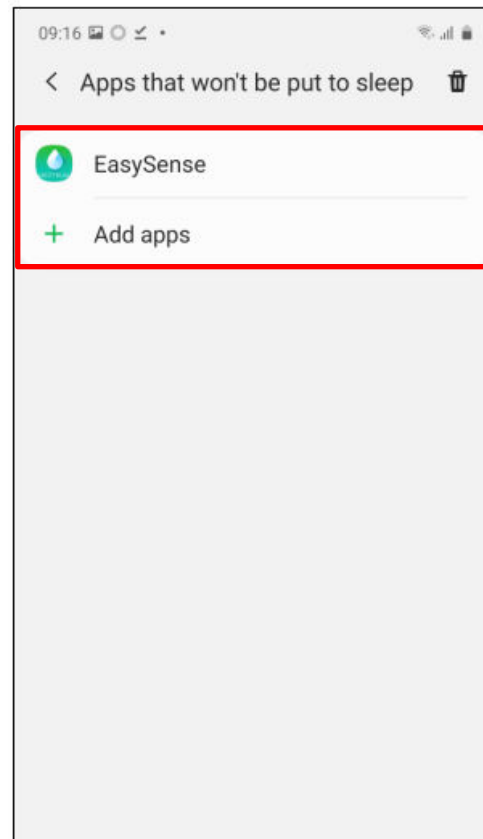

6. Lock Setting

- Tap the lock icon to lock Medtrum App in the background.
For Android system below 9.0:

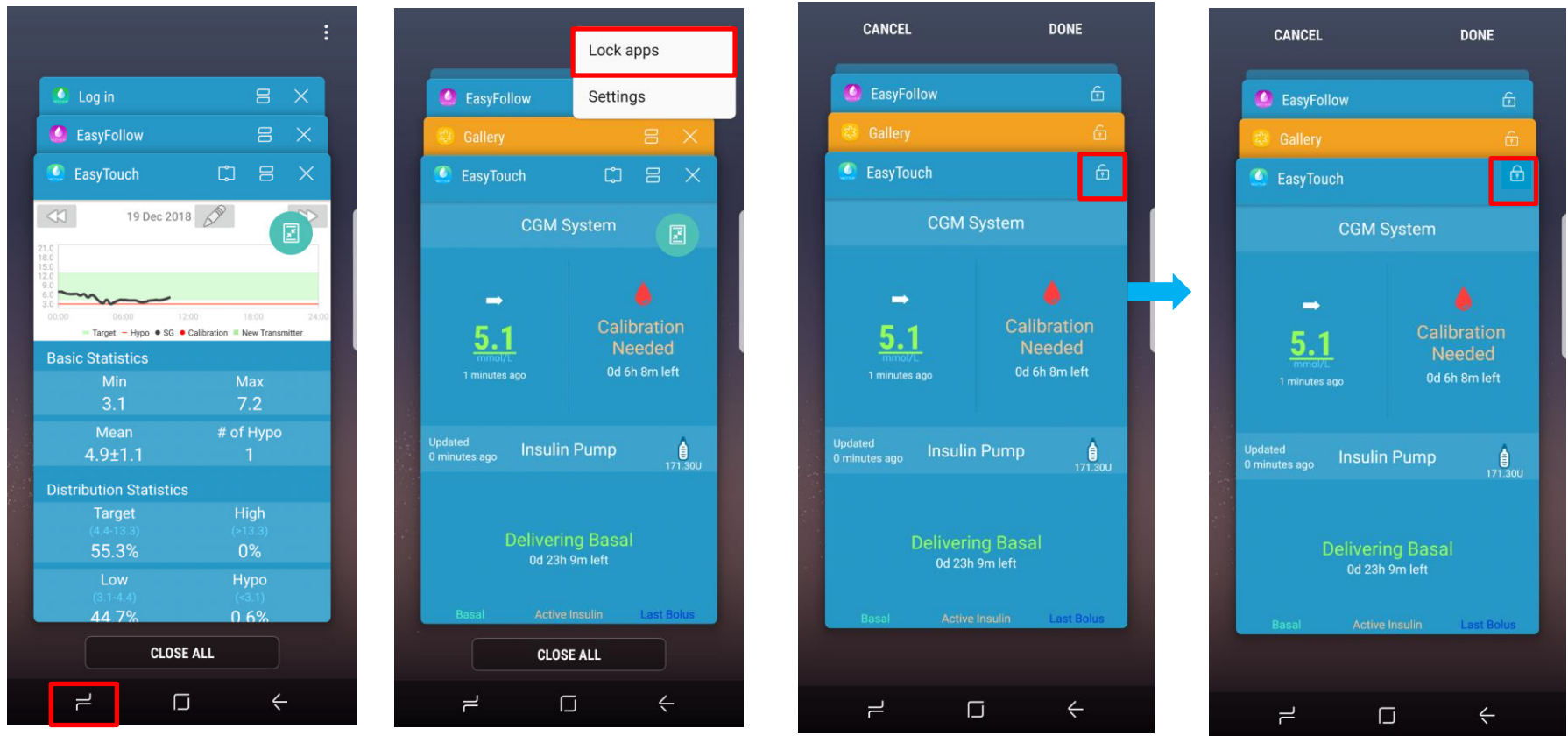

6. Lock Setting

For Android system 9.0 and above:

